

STRIKES

STRIKES

CAL-ROYAL

ASA Strikes



CR-ASA478
US3, 10, 10B, 26, 32D
ASA Strike

CR-ASAST
US3, 26D
Steel ASA

STRIKES

DON-JO

Deadbolt Type ANSI Strike



Stock No.
DJ-BFD2 BP Steel Brass Plated
DJ-BFD2 SL Steel Silver Coated

4-7/8" X 1-1/4"
13ga. (.095)

Blank ANSI Strike



Stock No.
DJ-BS161 605 Solid Brass
DJ-BS161 612 Solid Bronze
DJ-BS161 626 Dull Chrome
DJ-BS161 630 Stainless Steel

4-7/8" X 1-1/4"
13ga. (.095)

Deadbolt Strike



Stock No.
DJ-DBS1478 605 Polished Brass
DJ-DBS1478 626 Satin Chrome

4-7/8" X 1-1/4"
13ga. (.095)

ASA Mortise Strikes



Stock No.
DJ-MST261 BP Steel Brass Plated
DJ-MST261 SL Steel Silver Coated

4-7/8" X 1-1/4"
13ga. (.095)

Standard ANSI Strike



Stock No.
DJ-ST161 605 Solid Brass Lacquered
DJ-ST161 612 Solid Bronze Lacquered
DJ-ST161 625 Brass, Bright Chrome Plated
DJ-ST161 626 Brass, Dull Chrome Plated
DJ-ST161 630 Stainless Steel

Stock No.
DJ-ST261 BP Steel Brass Plated

4-7/8" X 1-1/4"
13ga. (.095)

T Strike



Stock No.
DJ-TS-234 605 Polished Brass
DJ-TS-234 630 Stainless Steel

2-3/4" X 1-1/8"
18ga. (.050)

©ZIPF LOCK COMPANY

500_{v2}
(PL-49)

SUPER SPECIAL PRICING AVAILABLE ON ITEMS MARKED WITH ■ - SUPPLIES LIMITED - PLEASE INQUIRE.

STRIKES

DON-JO

STRIKES

2-1/4" Extended Lip Strike

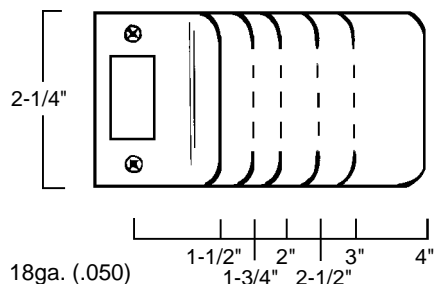

Stock No.	Finishes	Size
DJ-EL102	605, 609, 619, 620, 630, DU	2-1/4" x 2"
*DJ-9102	605, 619, 620	2-1/4" x 2"
DJ-EL103	605, 609, 630	2-1/4" x 3"
DJ-EL104	605, 609, 630	2-1/4" x 4"
DJ-EL115	605, 609, 619, 630, DU	2-1/4" x 1-1/2"
*DJ-9115	605, 609, 619, 630, DU	2-1/4" x 1-1/2"
DJ-EL125	605, 609, 630, DU	2-1/4" x 2-1/2"
*DJ-9125	605	2-1/4" x 2-1/2"
DJ-EL175	605, 619, 630, DU	2-1/4" x 1-3/4"
*DJ-9175	605, 619, 630, DU	2-1/4" x 1-3/4"

*SAVE MONEY: DJ-9102, DJ-9103, DJ-9115, DJ-9125 and DJ-9175 are polybagged and sold in multiples of 10.

2-3/4" Extended Lip Strike

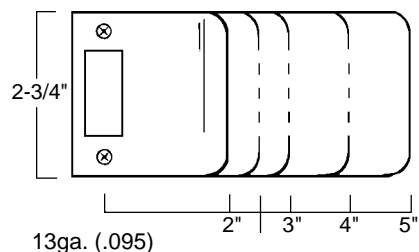

Stock No.	Finishes	Size
DJ-EL202	BP	2-3/4" x 2"
DJ-EL203	BP	2-3/4" x 3"
DJ-EL205	BP	2-3/4" x 5"

Don Jo Finishes:

- 605 Bright Brass
- 609 Antique Brass
- 612 Satin Bronze
- 619 Satin Nickel
- 620 Antique Nickel
- 630 Satin Stainless Steel
- BP Brass Plated
- DU Duro Coated

4-7/8" Extended Lip ANSI Strike

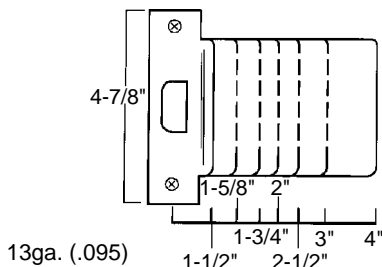

Stock No.	Finishes	Size
DJ-EST102	605, 612, 630	4-7/8" x 2"
DJ-EST103	605, 612	4-7/8" x 3"
DJ-EST104	605, 612, 630	4-7/8" x 4"
DJ-EST115	605, 612, 630	4-7/8" x 1-1/2"
DJ-EST125	605, 612, 630	4-7/8" x 2-1/2"
DJ-EST158	630	4-7/8" x 1-5/8"
DJ-EST175	612	4-7/8" x 1-3/4"

2-3/4" Extended Lip T-Strike

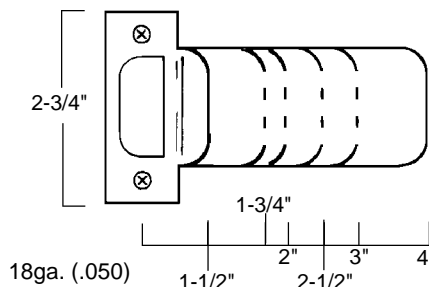

Stock No.	Finishes	Size
DJ-ETS102	605, 609, 630	2-3/4" x 2"
DJ-ETS103	605, 630	2-3/4" x 3"
DJ-ETS115	630	2-3/4" x 1-1/2"
DJ-ETS125	605	2-3/4" x 2-1/2"
DJ-ETS175	605, 630	2-3/4" x 1-3/4"

Security Strikes - display packed



DJ-2SDS

For Deadbolt



DJ-2SS

For Key-in-knob



DJ-2SDS 8

Super strike for deadbolt

Stock No.	Finish	Size
DJ-2SDS BP	Steel Brass Plated	4-7/8" x 1-1/4"
DJ-2SDS SL	Steel Silver Coated	4-7/8" x 1-1/4"
DJ-2SS BP	Steel Brass Plated	4-7/8" x 1-1/4"
DJ-2SS SL	Steel Silver Coated	4-7/8" x 1-1/4"
DJ-2SDS 8 SL	Steel Silver Coated	8" x 1-3/8"

13 ga. (.095). Supplied with four 3" screws for extra security.

©ZIPF LOCK COMPANY

SUPER SPECIAL PRICING AVAILABLE ON ITEMS MARKED WITH ■ - SUPPLIES LIMITED - PLEASE INQUIRE.

501^{v3}
(PL-49)

STRIKES

DON-JO

STRIKES

SERIES 8 STRIKE

Single Hole Version

Single hole version designed to work with key-in-knob or dead-bolt.

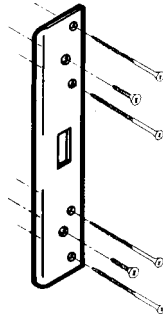

<u>Stock No.</u>	<u>Finish</u>	<u>Size</u>
DJ-FL208N BP	Brass Plated	8" X 1-3/8"
DJ-FL208W BP	Brass Plated	8" X 1-3/4"
DJ-FL208W SL	Silver Coated	8" X 1-3/4"
DJ-FL208W WH	White Coated	8" X 1-3/4"

SERIES 12 STRIKE

Single Hole Version

Single hole version designed to work with key-in-knob or dead-bolt.

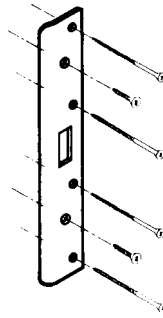

<u>Stock No.</u>	<u>Finish</u>	<u>Size</u>
DJ-FL212W BP	Brass Plated	12" X 1-3/4"

Double Hole Version

Double hole version designed to accommodate both 3-5/8" and 4" centered locksets.

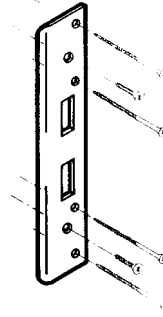

<u>Stock No.</u>	<u>Finish</u>	<u>Size</u>
DJ-FL212W4 BP	Brass Plated	12" X 1-3/4"

Double Hole Version

Double hole version designed to accommodate 6" center holes.

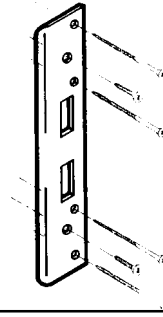

<u>Stock No.</u>	<u>Finish</u>	<u>Size</u>
DJ-FL212N6 SL	Silver Coated	12" X 1-3/8"
DJ-FL212W6 BP	Brass Plated	12" X 1-3/4"
DJ-FL212W6 SL	Silver Coated	12" X 1-3/4"
DJ-FL212W6 WH	White Coated	12" X 1-3/4"

SERIES 18 STRIKE

Single Hole Version

Single hole version designed to work with key-in-knob or dead-bolt.

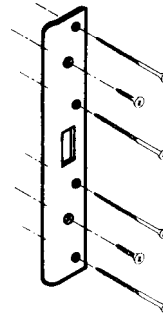

<u>Stock No.</u>	<u>Finish</u>	<u>Size</u>
DJ-AST21341 BP	Brass Plated	18" X 1-3/4"

©ZIPF LOCK COMPANY

502_{v3}
(PL-49)

SUPER SPECIAL PRICING AVAILABLE ON ITEMS MARKED WITH ■ - SUPPLIES LIMITED - PLEASE INQUIRE.

STRIKES

DON-JO

STRIKES

SERIES 18 STRIKE

Double Hole Version

Double hole version designed to accommodate both 3-5/8" and 4" centered locksets.

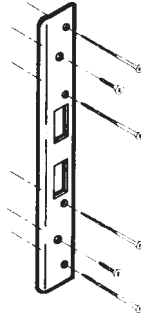

Stock No.	Finish	Size
DJ-AST21342 BP	Brass Plated	18" X 1-3/4"
DJ-AST21342 SL	Silver Coated	18" X 1-3/4"
DJ-AST21382 BP	Brass Plated	18" X 1-3/8"
DJ-AST21382 SL	Silver Coated	18" X 1-3/8"

Double Hole Version

Double hole version designed to accommodate 6" center holes.

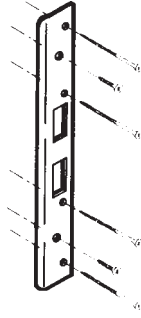

Stock No.	Finish	Size
DJ-AST21346 BP	Brass Plated	18" X 1-3/4"
DJ-AST21346 SL	Silver Coated	18" X 1-3/4"
DJ-AST21346 WH	White Coated	18" X 1-3/4"
DJ-AST21386 BP	Brass Plated	18" X 1-3/8"

Mortise Lock Version

Mortise hole version with "universal" center hole.

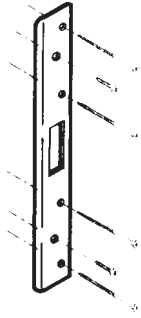

Stock No.	Finish	Size
DJ-AST2134M BP	Brass Plated	18" X 1-3/4"
DJ-AST2134M SL	Silver Coated	18" X 1-3/4"

ADJUSTABLE SECURITY STRIKE

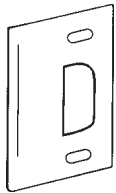

DJ-A2SS



DJ-A2SDS

Stock No.	Size	Description	Finish
DJ-A2SS BP	3-3/8" X 1-3/4"	Key in knob strike	Steel Brass Plated
DJ-A2SS SL	3-3/8" X 1-3/4"	Key in knob strike	Steel Silver Coated
DJ-A2SDS BP	3-3/8" X 1-1/4"	Deadbolt strike	Steel Brass Plated
DJ-A2SDS SL	3-3/8" X 1-1/4"	Deadbolt strike	Steel Silver Coated

**Cannot find what you need?
It simple ...
just give us a call...**



©ZIPF LOCK COMPANY

SUPER SPECIAL PRICING AVAILABLE ON ITEMS MARKED WITH ■ - SUPPLIES LIMITED - PLEASE INQUIRE.

503v1
(PL-49)

STRIKES

STRIKES FOR:

Kwikset
The Beauty of Strength™

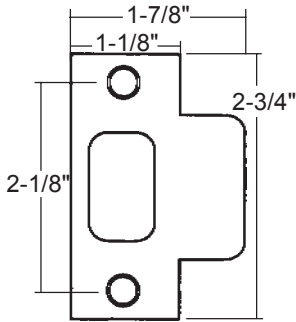

KW-83028 US-3, 26D
Metal Jamb Strike (TMS)
Not available on deadlocks

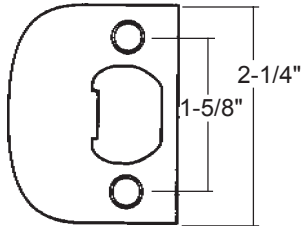

KW-83437
US-3, 5, 10B, 15, 15A
Standard Lockset Strike

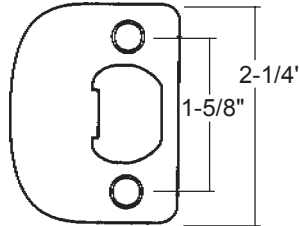

KW-83796
US-3, 5, 10B, 15, 26D
1/4" Radius Strike (RCS-4)

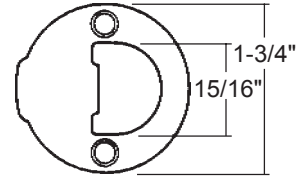

KW-83929 US-3, 5
Full round 1-3/4" metal jamb strike (includes metal and wood screws)

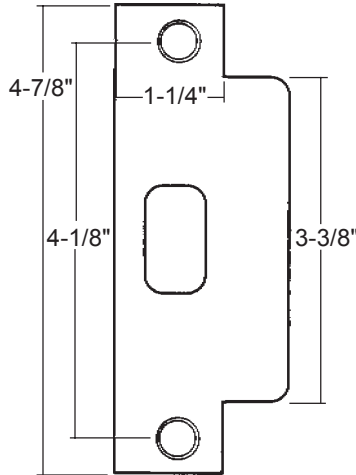

KW-80318 US-3, 5, 26D
Full round adjustable strike.



KW-83846 US-3, 26D
Metal Jamb Strike
1-1/4" x 4-7/8" ANSI
Not available on deadlocks

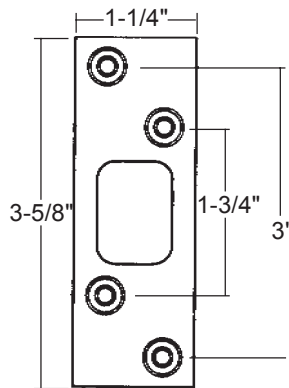

KW-83222
US-3, 5, 10B, 15, 15A, 26D
780, 785, 970, 975, 980, 985

KW-83223 (Radius Corner)
US-5, 10B, 15A
780, 785, 970, 975, 980, 985

FINISHES:

US-3 (605)	Polished Brass
US-LO3 (605E)	Polished Brass-Life
US-5 (609)	Antique Brass
US-10B (613)	Oil Rubbed Bronze
US-15 (619)	Satin Nickel
US-15A (620)	Antique Nickel
US-26 (625)	Polished Chrome
US-26D (626)	Satin Chrome

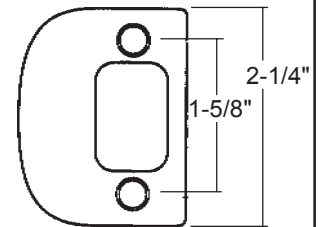

KW-84638 US-3, 26D
Deadbolt strike with lip

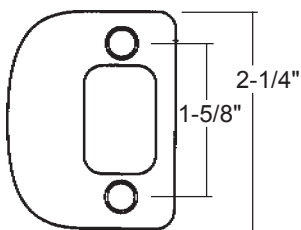

KW-85303 US-10B, 15
Deadbolt strike with lip. 1/4" radius corners.

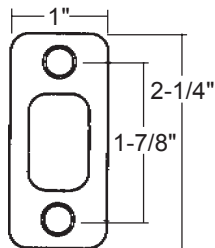

KW-85063
US-3, 5, 15, 15A, 26D
660 Series Deadlock Strike
Round corner strike

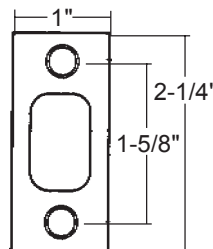

KW-85072
US-3, 15, 15A, 26D
660 Series Deadlock Strike
Square corner strike

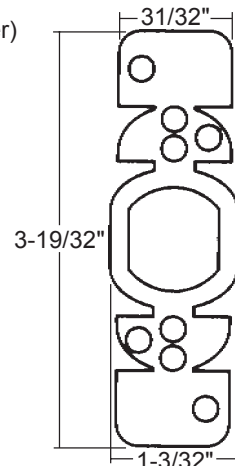

KW-81640 Strike Box
Plastic door jamb deadbolt strike insert for cleaner installation

©ZIPF LOCK COMPANY

STRIKES



WELDABLE GATE BOXES

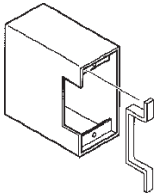

KD-K-BXES1

For installing Trine 005 and Rofu 1106 electric strikes.

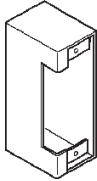

KD-K-BXES2

For installing Rofu 1402, 1702 and 3402 electric strikes. Also Rutherford 7 Series.

SECURITY STRIKES

- Heavy gauge steel.
- Brass plated.
- Supplied with 1-1/2" screws.
- Individual poly bagged.



PG-9620



PG-9630

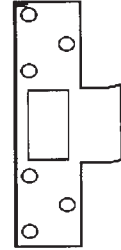

PG-9640

Stock No.	Size
PG-9620	10" x 1-1/4"
PG-9630	5-7/8" x 1-1/8"
PG-9640	5-7/8" x 1-1/8"

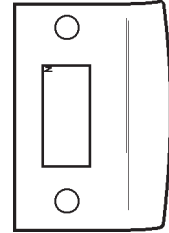

PG-73

Passage Strike-
Curved Lip
Brass Plated

STRIKES



SC-10-001

605, 612, 613, 626
Standard Strike
SIZE: 2-3/4" x 1-1/8" x 3/32"



SC-10-025

605, 612, 613, 626
Strike for ANSI preparation
SIZE: 4-7/8" x 1-1/4" x 3/32"

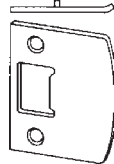

SC-10-026

605, 626
Full Lip Standard Strike

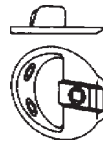

SC-10-058

605
Circular, adjustable
1-3/4" diameter
deadlatch strike

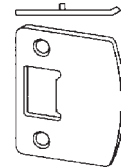

SC-10-027

605, 626
1/4" Radius Rounded
Corner Full Lip Strike

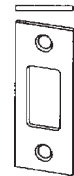

SC-10-094

605, 626
BC160, B360, BR260
Standard Strike
Square Corner

**We pride ourselves on our customer service.
We urge you to test us today and every day!**

©ZIPF LOCK COMPANY

SUPER SPECIAL PRICING AVAILABLE ON ITEMS MARKED WITH ■ - SUPPLIES LIMITED - PLEASE INQUIRE.

505v2
(PL-49)