

CAM LOCKS



Available by special order

DOUBLE BITTED CAM LOCKS

- Eleven crisscross blade tumbler plug in 3/4" diameter.
- Die Cast barrel with two flats—5/8" across.
- Key and cam rotation 90° from locked (12 O'clock) to unlocked (3 O'clock) position with keypull in locked position only.
- Straight cam furnished is 1/8" thick x 3/4" wide.
- Standard finish: Polished Nickel.
- Two keys furnished per lock.

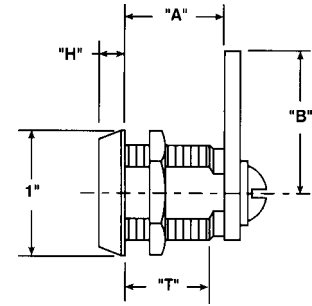
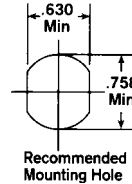

1801 Series

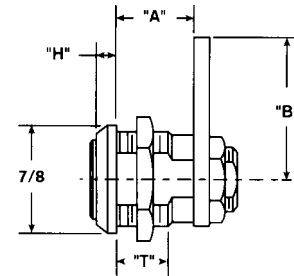

3186, 3205 Series

Stock No.	A	B	H	I	Keyed Alike Numbers Available
C1801	13/16"	1-1/8"	13/64"	11/16"	2001 (No KD)
C1802	1-1/16"	1-1/8"	13/64"	15/16"	2001 (No KD)
C3186	5/8"	1-1/8"	5/32"	13/32"	2001, 2007
C3205	7/16"	1-1/8"	13/64"	15/64"	2001, 2007

Most Locks available **KV***-Keyed Different or **KA**-Keyed Alike.

Specify KD or KA

*KV indicates the majority of the quantity of locks will be keyed different. A lesser quantity will potentially be keyed alike to one or more key numbers. We can not guarantee that we can ship keyed DIFFERENT locks.

ACE II® 7 PIN TUMBLER CAM LOCKS

- All brass construction.
- Patented Ace II® assembly.
- Center plug contains anti-drill pin for added security.
- Furnished with straight locking cams which can be mounted vertically or horizontally and also a 1/4" offset cam. Cams are 1/8" thick x 3/4" wide..
- Standard finish: Polished Nickel.
- Two keys furnished per lock.

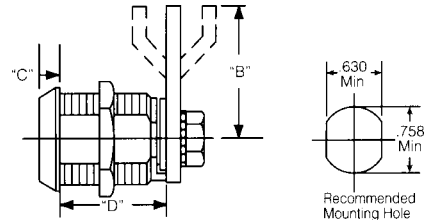

Stock No.	B	C	D	Keyed Alike Numbers Available
C4153	1-1/8"	1/4"	11/16"	PL505, PL910, 6234, 6030*
C4160	1-1/8"	13/64"	1-3/32"	6234, PL960*

*These keyed alike numbers are discontinued—limited supply.

Most Locks available **KD**-Keyed Different or **KA**-Keyed Alike. **Specify KD or KA**

Key rotation/Removal is determined by the STOP CAM you select and how it is positioned. A) 180° clockwise rotation-key removal at 12 O'clock; B) 180° counter clockwise rotation-key removal at 12 O'clock; C) 90° clockwise rotation-key removal at 12 & 3 O'clock; D) 90° counter clockwise rotation-key removal at 12 & 9 O'clock;

©ZIPF LOCK COMPANY

CAM LOCKS



1000 SERIES HIGH SECURITY GEM CIRCULAR K137 KEYWAY

- 7 pin tumbler.
- Multi-function.
- Standard finish: Nickel Plated.
- Two keys furnished per lock.

Locks feature Flex Cam. Three spacers offer three different thicknesses to fine tune the fit. Just insert the proper spacer into the hole in the cam.

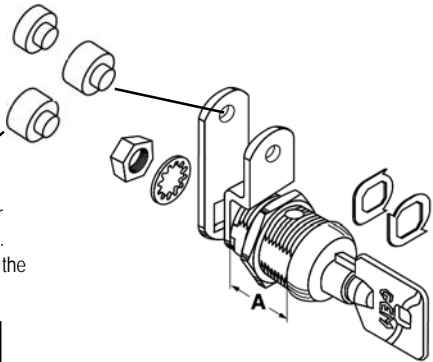

Stock No.	A	Keyed Alike Numbers Available
MFW-1038	1/2"	27381, 27385
MFW-1058	23/32"	27379, 27380, 27382, 27384, 27385
MFW-1078	15/16"	27379, 27381, 27382, 27385
MFW-1118	1-5/32"	27379, 27381, 27382, 27383
MFW-1148	1-1/2"	27379, 27382, 27383

Contains:	
Lock	90° Stop Washer
Wonder Washer	Straight Cam
Spur Washer	1/4" Bent Cam
3/4" Nut	Cam hole adapter
180° Stop Washer	Screw

Most Locks available **KD**-Keyed Different or **KA**-Keyed Alike. **Specify KD or KA**

Keyed Different— Locks ordered KD will be supplied with random keying. Some duplication of codes is possible.

23000 SERIES CAM LOCKS SINGLE BITTED

- Single bitted.
- Universal Keyway—K54G. (See next page)
- Multi-function
- Finish: Stainless Steel or brass.
- Two keys furnished per lock.

Contains:	
Lock	90° Stop Washer
Wonder Washer	Straight Cam
Spur Washer	1/4" Bent Cam
3/4" Nut	Spline Fillers
180° Stop Washer	Screw

Locks feature Flex Cam. Three spacers offer three different thicknesses to fine tune the fit. Just insert the proper spacer into the hole in the cam.

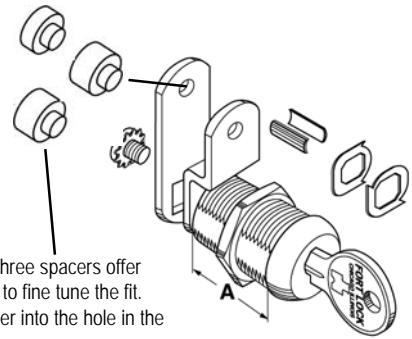

STAINLESS STEEL FINISH

Stock No.	A	Keyed Alike Numbers Available
MFW-23038	7/16"	217, 221, 224, 237, 238
MFW-23058	5/8"	217, 221, 224, 237, 238
MFW-23078	7/8"	217, 221, 224, 237, 238
MFW-23118	1-1/8"	217, 221, 224, 237, 238
MFW-23138	1-3/8"	217, 221, 224, 237, 238
MFW-23168	1-3/4"	217, 221, 224, 237, 238

BRASS FINISH

Stock No.	A	Keyed Alike Numbers Available
MFW-23038B	7/16"	221
MFW-23118B	1-1/8"	221
MFW-23138B	1-3/8"	
MFW-23168B	1-3/4"	217, 221

Most Locks available **KD**-Keyed Different or **KA**-Keyed Alike. **Specify KD or KA**

Keyed Different— Locks ordered KD will be supplied with random keying. Some duplication of codes is possible.

2" STRAIGHT CAMS

Stock No.	"A"	For
SF3200 2"	2"	Flat Lock
SG3200 2"	2"	Gem Lock

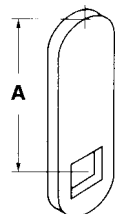

Need a COMPX product not in our catalog??
Just give us a call with your needs !!



©ZIPF LOCK COMPANY

SUPER SPECIAL PRICING AVAILABLE ON ITEMS MARKED WITH ■ - SUPPLIES LIMITED - PLEASE INQUIRE.

253 v3
(PL-19)

CAM LOCKS



29000 SERIES HIGH SECURITY DOUBLE BITTED CAM LOCKS

- Double Bitted—5 tumblers.
- Keyway: K775
- Multi-function.
- Standard finish: Stainless Steel.
- Two keys furnished per lock.

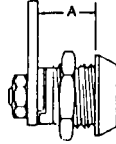

Contains:	
Lock	90° Stop Washer
Wonder Washer	Straight Cam
Spur Washer	1/4" Bent Cam
3/4" Nut	Spline Fillers
180° Stop Washer	Screw

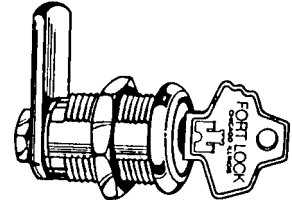

<u>Stock No.</u>	<u>A</u>	<u>Keyed Alike Numbers Available</u>
MFW-29058	5/8"	D3045
MFW-29078	7/8"	D3059
MFW-29118	1-1/8"	D3045, D3059
MFW-29138	1-3/8"	D3012, D3059, D3085, D3165

"Floating" tumblers-cylinder turns slightly and wedges tumblers into a secondary double locked position if picking is attempted. Key will realign tumblers when used.

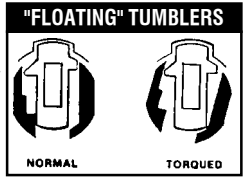

Most Locks available **KD**-Keyed Different or **KA**-Keyed Alike. **Specify KD or KA**

Keyed Different— Locks ordered KD will be supplied with random keying. Some duplication of codes is possible.

The Concept of Multi-Function:

The concept of Multi-Function is to make one bag of components available to produce many different functioning locks (up to 6 different functions in Fort's single bitted bag). This enables the locksmith to carry fewer locks in inventory while still have complete stock on hand. Multi-Function bagged cam locks include Fort's patented Wonder Washer, which allows for installation into either wood or metal without the use of a double "D" punch.

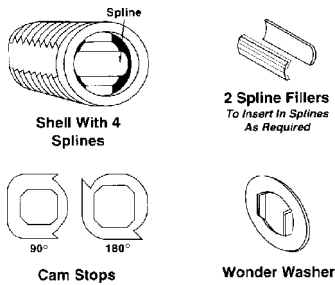

LOCKS PROVIDED WITH PARTS FOR SIX DIFFERENT FUNCTIONS				
Function	Key Rotation	Key Removeable at:	Parts Used	
			Cam Stop	Spline Filler Placed at:
1	12-3 CW	12	90° RT	3:00 & 9:00
2	12-3 CW	12, 3	90° RT	—
3	12-6 CW	12, 6	180° RT	3:00 & 9:00
4	12-9 CCW	12	90° LFT	9:00 & 3:00
5	12-9 CCW	12, 9	90° LFT	—
6	12-9 CCW	12, 6	180° LFT	9:00 & 3:00

UNIVERSAL KEYING MATRIX

Fort's 23000 series cam locks are designed with the Universal Keyway which accepts many other manufacturers' key blanks and will operate with their key code systems. (See chart at right)

This is important when you have another manufacturer's locking system in the field and you wish to build onto that existing system by adding locks made by Fort Lock and still use the same existing keys.

<u>MFG.</u>	<u>Key Code</u>	<u>MFG.</u>	<u>Key Code</u>	<u>MFG.</u>	<u>Key Code</u>
All-Lock	PK502-999	LLMK	LL201H-LL225H	Hurd	LL201H-LL225H ^s
CCL	AMxxx codes	ESP	ALxxx		2077-2099 ^s
Chicago	FAB24		ES101-204		2051-2101
	LL226-LL275		SL342		GH067
	W1000-W1050 ^E		UC380		603
	W1000-	Hudson	HL-201-400	Ilco	EB1-240
	W1050 ^{ES}		HC714-840	Lori	C001A-633A
	LL61-LL139		MM750-999	National	D127A
	LL61-LL139 ^s		HL959		
	LL331	Hurd	2001-2050		
	1250-1499		2001-2050 ^s		

^E Even numbers
^s Sears

CAM LOCKS

PIN TUMBER CYLINDER CAM LOCKS—BRASS CONSTRUCTION



Cam Dimensions

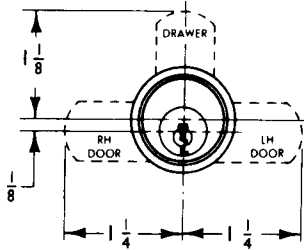

Through the use of a shifter, the 360° key turn turns the cam 90° in either direction. Actual application determines which cam position is the locked position. Each lock is furnished with an alternate cam for opposite cam turn

Applications: solid lines show locked position of cam	Position of shifter on back of lock	Applications: solid lines show locked position of cam	Position of shifter on back of lock

**LIPPED/
OVERLAY**
NL-C8103
NL-C8109

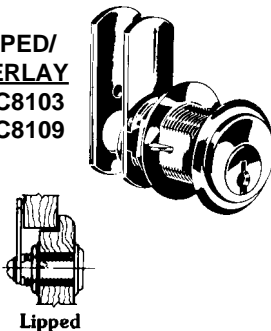

APPLICATION—For drawers, RH or LH doors. NL-C8103 and NL-C8109 are for lipped or overlay construction. For overlay application, the combined thickness of front and frame cannot exceed the cylinder length. Also see overlay detail below. The other locks are for flush applications.

OPERATION—90° cam turn, key removable in both locked and unlocked positions.

KEYING—Will key together with all other pin tumbler locks using D4291 key blank except NL-C8700 series mail box locks. See table for available keying.

KEY BLANK—D4291.

FINISH—4-Satin Brass, 26D-Dull Chrome (Brushed)

PACKAGING—Supplied with two keys, trim washer, spur washer for wood, mounting nut and two cams.

FLUSH
NL-C8106
NL-C8108

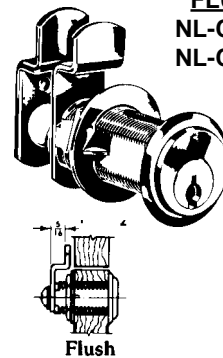

The NL-C8102, is a Multi-Functional Pin Tumbler cam lock with a 1-1/16" cylinder length. The lock is packaged with four (4) cams, two straight and two double formed. This allows the lock to be used for multiple applications for either drawer or right hand/left hand with lipped or overlay construction.

<u>Stock No.</u>	<u>Type of Mounting</u>	<u>Cylinder Length</u>	<u>Maximum Material Thickness</u>	<u>Finishes</u>	<u>Keyed Alike Numbers Available</u>
NL-C8103	Lipped/Overlay	1-3/16"	7/8"	4, 26D	26D-101, 107
NL-C8106	Flush	1-7/16"	1-1/8"	4, 26D	4-107, 26D-107, 915
NL-C8108	Flush	1-3/4"	1-3/8"	4, 26D	107, 915
NL-C8109	Lipped/Overlay	1-3/4"	1-1/2"	26D	26D-107

Most Locks available **KD**-Keyed Different or **KA**-Keyed Alike. **Specify KD or KA**

Combi-Cam™

The Best Combined Cam Lock on the Market!



Securely lock drawers, doors & more without the need for keys.

Cam Lock—(Chrome)

<u>Stock No.</u>	<u>Length</u>
CC-7850L	1-1/8"
CC-7850M	7/8"
CC-7850S	5/8"

No Keys to Hassle With!!

The Combi-Cam is a secure solid metal cam lock with 1,000 possible combinations. Best of all, unlike the competition, it requires no expensive kits nor the arduous task of entirely taking apart the lock replacing disks!

Changing the combination is simple. With the lock set on the opening combination, push in the reset button while setting the new combination. IT IS THAT EASY!

Great product for when keys are a hassle or when frequent lock changes are needed!!

Accessories—

<u>Stock No.</u>	<u>Description</u>
CC-7850-FP	Finger Pull
CC-7850-OC	2" offset cam

©ZIPF LOCK COMPANY

SUPER SPECIAL PRICING AVAILABLE ON ITEMS MARKED WITH ■ - SUPPLIES LIMITED - PLEASE INQUIRE.

255 v3
(PL-19)

CAM LOCKS

DISC TUMBER CYLINDER CAM LOCKS

Mounting Holes for all Cam Locks

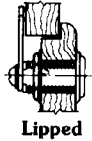
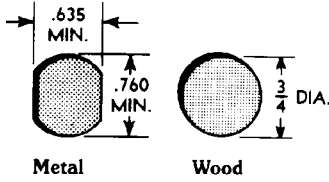

Lipped

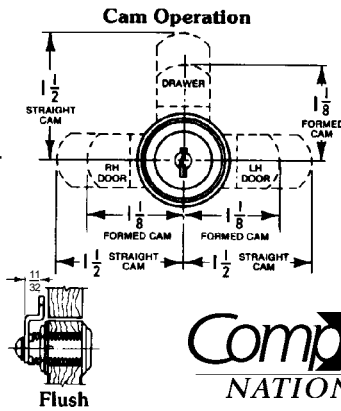

Flush

CompX
NATIONAL

APPLICATION—For drawers, RH or LH doors with lipped / overlay construction (straight cam) or flush construction (formed cam). For overlay application, the combined thickness of front and frame cannot exceed the cylinder length. Also see overlay detail below.

OPERATION—90° cam turn on all locks. Key removable in both locked and unlocked positions.

KEYING—Will key together with all other disc tumbler locks using D8785 key blank. Available keyed alike or keyed different. See keyed alike numbers below.

KEY BLANK—D8785

FINISH—3-Bright Brass, 4G-Antique Brass, 14A-Bright Nickel

PACKAGING—Supplied with two keys, trim washer, spur washer for wood, mounting nut and two cams.

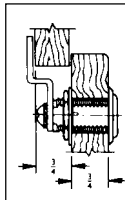

OVERLAY

Stock No

NL-C7014-2C Cam

The NL-C8053 lock using the NL-C7014-2C cam (order separately) accommodates overlay construction using a 3/4" thick front and 3/4" thick frame. 1-5/8" long.

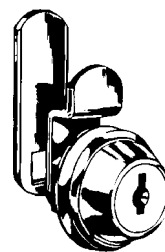

NL-C8051

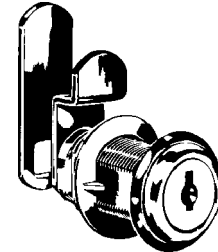

NL-C8052, NL-C8053
NL-C8054, NL-C8055

Locks furnished with straight cam assembled.

Stock#	Type of Mounting	Cylinder Length	Maximum Material Thickness	Finishes	Keyed Alike Numbers Available
NL-C8051		7/16"	7/64"	3, 14A	See chart below
NL-C8052	Lipped/Overlay	5/8"	15/64"	3, 14A	See chart below
NL-C8053	or	1-3/16"	7/8"	3, 4G, 14A	See chart below
NL-C8054	Flush	15/16"	5/8"	3, 14A	See chart below
NL-C8055		1-7/16"	1-1/8"	3, 14A	See chart below

Most Locks available **KD**-Keyed Different or **KA**-Keyed Alike. **Specify KD or KA**

KEYED ALIKE NUMBERS AVAILABLE:

NL-C8051-3 C413A

NL-C8052-3 C346A, C413A, C415A

NL-C8052-14A C346A, C642A

NL-C8053-3 C346A, C390A, C413A, C642A

NL-C8053-4G C390A

NL-C8053-14A C346A, C390A, C413A, C415A, C420A, C642A

NL-C8054-3 C413A, C415A

NL-C8054-14A C346A, C390A, C413A, C415A, C420A, C642A

NL-C8055-3 C346A, C390A, C420A

NL-C8055-14A C346A, C413A, C415A, C420A



SlamCAM Coverts Cam Lock to Self-Locking

NL-C7017 SlamCam

Self-locking SlamCAM – spring loaded latch. True convenience — release the key, and the self-locking component automatically returns the lock, along with SlamCAM, to the locked position. SlamCAM, a spring loaded latch, along with the self locking component, **converts CompX National cam locks (C8051-C8075) into self-locking cam locks.** **PACKAGING:** Packaged with SlamCAM, self-locking component, four spacers, washer and three mounting screws. **SLAMCAM DIMENSIONS:** 13/16" wide, 1-7/16" high, 25/32" deep

Note: Since the self-locking component adds 5/16" to the length of the lock be sure to order the correct length cam lock. **INSTALLATION NOTE:** For C8051 and C8052, the washer must be installed between the cylinder and the self-locking component to secure the lock plug properly.

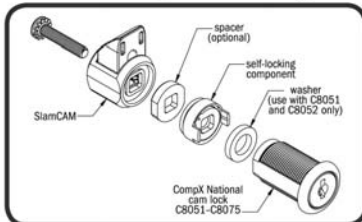

©ZIPF LOCK COMPANY

CAM LOCKS

DISC TUMBLER CYLINDER CAM LOCKS WITH FLEXAFUNCTION



Mounting Holes for all Cam Locks

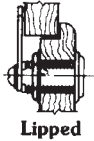
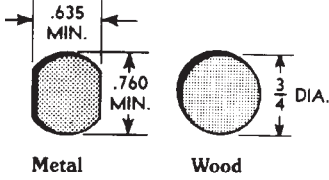

Cam Operation

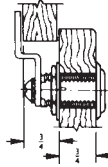
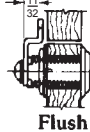
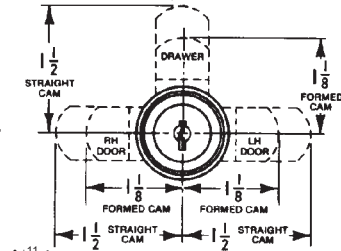

OVERLAY

Stock No

NL-C7014-2C Cam

The NL-C8073 lock using the NL-C7014-2C cam (order separately) accommodates overlay construction using a 3/4" thick front and 3/4" thick frame. 1-5/8" long.

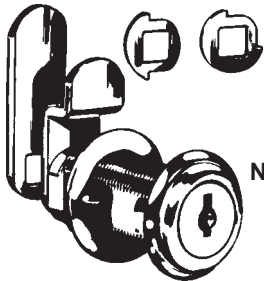

NL-C8060, NL-C8073, NL-C8075

Assembled with straight cam and 90° cam rotation

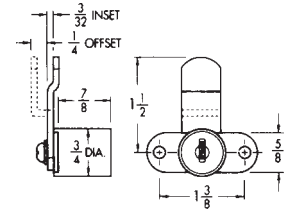
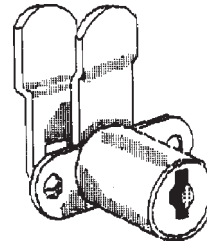

NL-C8080

Assembled for 90° cam turn

APPLICATION—For drawers, RH or LH doors with lipped /overlay construction (straight cam) or flush construction (formed cam). For overlay application, the combined thickness of front and frame cannot exceed the cylinder length. Also see overlay detail above.

OPERATION—Choice of either 90° or 180° cam turn. Key removable in both locked and unlocked positions.

KEYING—Will key together with all other disc tumbler locks using D8785 key blank. Available keyed alike or keyed different. See keyed alike numbers below.

KEY BLANK—D8785

FINISH—3-Bright Brass, 4G-Antique Brass, 14A-Bright Nickel

PACKAGING—Supplied with two keys, trim washer, spur washer for wood, mounting nut, two cams and two stop washers.

APPLICATION—For doors and drawers. Surface mounted. Requires 3/4" dia. hole for cylinder.

OPERATION—Choice of either 90° or 180° cam turn. Key removable in both locked and unlocked positions.

KEYING—Will key together with all other disc tumbler locks using D8785 key blank. Available keyed alike or keyed different. See keyed alike numbers below.

KEY BLANK—D8785

FINISH—3-Bright Brass, 4G-Antique Brass, 14A-Bright Nickel

PACKAGING—Supplied with two keys, two mounting screws, two formed cams and two stop washers. Assembled for 90° cam turn.

Stock#	Type of Mounting	Cylinder Length	Maximum Material Thickness	Finishes	Keyed Alike Numbers Available
NL-C8060	Lipped/	1-3/4"	1-7/16"	3, 4G, 14A	See chart below
NL-C8073	Overlay	1-3/16"	7/8"	3, 4G, 14A	See chart below
NL-C8075	or	1-7/16"	1-1/8"	3, 14A	See chart below
NL-C8080	Flush	7/8"	7/8"	3, 4G, 14A	See chart below

Most Locks available **KD**-Keyed Different or **KA**-Keyed Alike. *Specify KD or KA*

KEYED ALIKE NUMBERS AVAILABLE:

NL-C8060-3 C415A
 NL-C8060-14A C346A, C390A, C415A
 NL-C8073-3 C346A, C390A, C415A, C642A
 NL-C8073-4G C390A, C415A, C642A
 NL-C8073-14A C346A, C390A, C413A, C415A, C420A, C642A
 NL-C8075-3 C390A, C413A, C415A

NL-C8075-14A C346A, C390A, C413A, C415A, C420A
 NL-C8080-3 C390A
 NL-C8080-4G C413A
 NL-C8080-14A C346A

SUPER SPECIAL PRICING AVAILABLE ON ITEMS MARKED WITH ■ - SUPPLIES LIMITED - PLEASE INQUIRE.

257 v1
(PL-19)

CAM LOCKS



SMALL PIN - NATIONAL KEYWAY

GENERAL FEATURES—

Rekeyable: Easily rekeyable via cylinder retainer clip

Body: Zinc die cast lock body

Cylinder: Zinc die cast pin tumbler cylinder

Functions: Non-key retaining (standard). Alternate key-retaining shifters are available separately.

Cams: 2 reversible cams work in all positions

Face: 1" face covers splintering, no additional trim ring required

Finish: 26D. *Other finishes by special order.*

KEYING INFORMATION—

Keyway: National D4291 (4 pin)

Stock keying: KD/KA - 4 pin standard

Stock KA#: 915. *Other KA# by special order.*

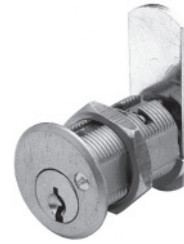
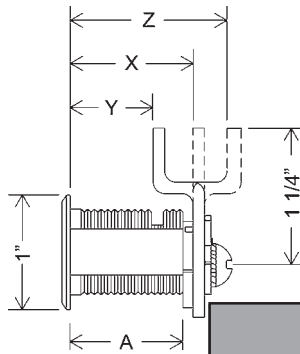

Stock No.
OS-DCN1-26D KD
OS-DCN1-26D KA915
OS-DCN2-26D KD
OS-DCN2-26D KA915
OS-DCN4-26D KD
OS-DCN4-26D KA915

	For Mat. Thickness	Straight Cam(X)	Inbent Cam(Y)	Outbent Cam(Z)	Cylinder Length(A)
OS-DCN1	3/4"	1-1/16"	3/4"	1-3/8"	1"
OS-DCN2	7/8"	1-3/16"	7/8"	1-1/2"	1-1/8"
OS-DCN4	1-1/2"	1-13/16"	1-1/2"	2-1/8"	1-3/4"

IC CORE - SMALL FORMAT

GENERAL FEATURES—

Certifications: Passed ANSI/BHMA A156.11 Grade 1 performance requirements

Cylinder diameter: 1-1/8"

Hole Size: 1-5/32"; **Across flats:** 7/8"

Max. material thickness: 1-1/8"

Min. material thickness: 0.08"

Retrofits: Best 1E7D4 or 1E7E4

Functions: Includes all parts for key-retaining or non-key-retaining function

Body: Zinc die cast body

Finish: 26D. *Other finishes by special order.*

KEYING INFORMATION—

Cores: Not included. *Order seperately.*

Accepts: Best, Arrow, Falcon, KSP, Schlage SFIC or equivalent small format interchangeable cores

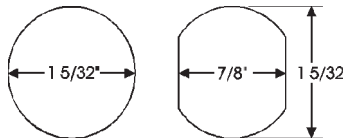

Stock No.
OS-720LM/DM-26D
 Less cores, see below for cores.

Includes:

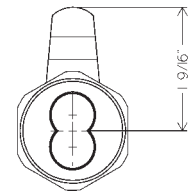
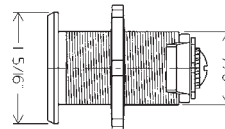
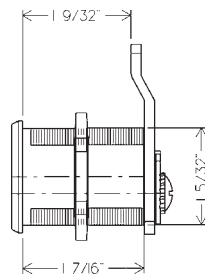

SMALL FORMAT CORES

Stock No. **Length**

AR-100CR-UC 6 pin

AR-7100CR-UC 7 pin



Keyways: 1D, AB, BB, DB, EB, FB, GB, HB, JB, KB, MB.

Finishes: 4-Satin Brass, 26D-Satin Chrome

To Order, Specify:

Stock No. Keyway and Finish (AR-C6S-UC AB 26D)